

Modular fuse-holder CE
for 10,3 x 38 mm 13/32 x 1 1/2 in. fuses

DIN 3

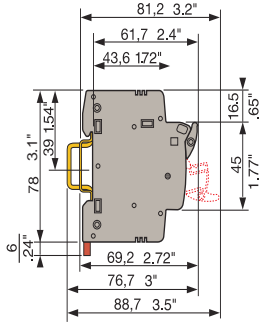

IP20 protection
Standards : IEC 947-3 / 269-2

Rail	35 x 7.5 x 1 PR30	prepunched	0164 800.03
Rail	35 x 15 x 2.3 PR4		0168 500.12
Rail	35 x 15 x 1.5 PR5	prepunched	0101 598.26

Pending – please consult us



The assembly of more than 3 modular fuse-holders equipped with fuses could downgrade rated current. Consult us.

Reference	FE10.1		FE8-10.N		FE10.1N.C		FE10.1N	
	Type	P/N	Type	P/N	Type	P/N	Type	P/N
Standard	FE10.1	8711 628.01	FE8-10.N	8711 627.01	FE10.1N.C	8721 628.01	FE10.1N	8715 628.01
With blown-fuse indicator 24-48 AC/DC / 48-115 VAC	FE10.1	8711 628.11						
With blown-fuse indicator 115-690 VAC	FE10.1	8711 628.12			FE10.1N.C	8721 628.12	FE10.1N	8715 628.12

Blown fuse-indicator leakage current :
< 0,5 mA at 24 V
< 1 mA at 48 V
< 2,5 mA at other voltages

Characteristics		IEC			UL			CSA					
		IEC	UL pending	CSA pending	IEC	UL	CSA	IEC	UL	CSA			
Wire size	Solid wire	0.5-16	20-6 AWG	20-6 AWG	0.5-16			0.5-10			0.5-16		
	Stranded wire	0.5-10			0.5-10			0.5-6			0.5-10		
mm ² AWG	Gauge	A5			A5			A4			A5		
Rated voltage	V AC ~/= DC	690	600	600	690			690			690		
Rated current	A	32	30	30	32			32			32		
Rated wire size	mm ² / AWG	6 mm ²	6 AWG	6 AWG	6 mm ²			6 mm ²			6 mm ²		
Wire stripping length	mm / inches	12 mm / .47"			12 mm / .47"			12 mm / .47"			12 mm / .47"		
Recommended torque	Nm / lb.in	1.2 Nm / 10.6 lb.in			1.2 Nm / 10.6 lb.in			1.2 Nm / 10.6 lb.in			1.2 Nm / 10.6 lb.in		

Accessories	Type	P/N		Type	P/N		Type	P/N		Type	P/N	
		Type	P/N		Type	P/N		Type	P/N		Type	P/N
	1 Plate mounting kit	FT1	0399 371.13	FT1	0399 371.13	FT1	0399 371.13	FT1	0399 371.13	FT1	0399 371.13	
	2 Assembly Kit multipolar	KE8-10	0206 125.24	KE8-10	0206 125.24	KE8-10	0206 125.24	KE8-10	0206 125.24	KE8-10	0206 125.24	
	3 Flat pin jumper bar unipolar	PCP.1.12	RAU8970 452.12	PCP.1.12	RAU8970 452.12	PCP.1.12	RAU8970 452.12	PCP.1.12	RAU8970 452.12	PCP.1.12	RAU8970 452.12	
	63 A unipolar	PCP.1.13	RAU8970 452.13	PCP.1.13	RAU8970 452.13	PCP.1.13	RAU8970 452.13	PCP.1.13	RAU8970 452.13	PCP.1.13	RAU8970 452.13	
	isolated IP20 unipolar	PCP.1.57	RAU8970 452.57	PCP.1.57	RAU8970 452.57	PCP.1.57	RAU8970 452.57	PCP.1.57	RAU8970 452.57	PCP.1.57	RAU8970 452.57	
	(see accessories, bipolar	PCP.2.12	RAU8970 453.12	PCP.2.12	RAU8970 453.12	PCP.2.12	RAU8970 453.12	PCP.2.12	RAU8970 453.12	PCP.2.12	RAU8970 453.12	
	page 154) bipolar	PCP.2.60	RAU8970 453.60	PCP.2.60	RAU8970 453.60	PCP.2.60	RAU8970 453.60	PCP.2.60	RAU8970 453.60	PCP.2.60	RAU8970 453.60	
	tripolar	PCP.3.12	RAU8970 454.12	PCP.3.12	RAU8970 454.12	PCP.3.12	RAU8970 454.12	PCP.3.12	RAU8970 454.12	PCP.3.12	RAU8970 454.12	
	tripolar	PCP.3.60	RAU8970 454.60	PCP.3.60	RAU8970 454.60	PCP.3.60	RAU8970 454.60	PCP.3.60	RAU8970 454.60	PCP.3.60	RAU8970 454.60	
	tetrapolar	PCP.4.12	RAU8970 455.12	PCP.4.12	RAU8970 455.12	PCP.4.12	RAU8970 455.12	PCP.4.12	RAU8970 455.12	PCP.4.12	RAU8970 455.12	
	tetrapolar	PCP.4.60	RAU8970 455.60	PCP.4.60	RAU8970 455.60	PCP.4.60	RAU8970 455.60	PCP.4.60	RAU8970 455.60	PCP.4.60	RAU8970 455.60	
	4 10,3 x 38 mm fuses (see accessories, page 154)	FU103					FU103					
	5 Flat pin terminal 15 mm	BTVP15	RAU8970 460.01	BTVP15	RAU8970 460.01	BTVP15	RAU8970 460.01	BTVP15	RAU8970 460.01	BTVP15	RAU8970 460.01	
	(25 mm ²) 30 mm	BTVP30	RAU8970 460.02	BTVP30	RAU8970 460.02	BTVP30	RAU8970 460.02	BTVP30	RAU8970 460.02	BTVP30	RAU8970 460.02	

R see section on markers

RC55 - RC510

RC55 - RC510

RC55 - RC510

RC55 - RC510